

RICOH
Interactive
Whiteboard
A6510
A7510
A8610

RICOH
imagine. change.





The RICOH Interactive Whiteboard A series has been reborn with improved usability and security.

The advanced EDLA-certified RICOH Interactive Whiteboard A series 2nd generation has improved security and supports many applications that can be conveniently used in corporate and educational scenes. It fosters smooth communication and maximizes collaboration. With intuitive operation similar to that of your smartphone, the RICOH Interactive Whiteboard A series 2nd generation is more user-friendly than ever.

RICOH Interactive Whiteboard A series 2nd generation



Key features

- Embedded Android and Google EDLA certified
- Expandable with Windows controllers
- Wirelessly connect to PCs and peripherals at hand
- As a starting point for communication, type in your idea instantly and share on the fly



Powerful and Feature-Rich Hardware Design



EDLA certified

Google Mobile Service (GMS) is available and comes pre-installed with useful Google applications, including Google Chrome and others. Google Play Protect also ensures that apps and devices are secure.



40-point multi-touch functionality with a smooth and comfortable operation

Up to 40 simultaneous touch points enable more active collaboration with multiple people writing at the same time. It can work seamlessly with the major operating systems including Windows, Android, Linux, Mac, and Chrome.

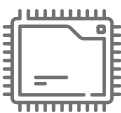

Large RAM/ROM

Peak performance with 8GB of RAM and 128GB of ROM for fast response and stable operation.



User comfort

Blue light cut function reduces eye fatigue. The anti-fingerprint finish on the screen surface resists fingerprints and smudges, and if smudges do stick, they can be removed with a light wipe.



Versatile connectivity with a front-facing interface

Supports a range of interfaces such as HDMI, USB, Microphone and the latest USB Type-C. The interface ports are mounted on the front of the IWB to make it easy to connect an external device.



Connect wirelessly

Supports Bluetooth (5.2) for wireless connection to audio and other devices. It also supports the latest Wi-Fi6 for high-speed communication.



Powerful audio

Equipped with a pair of 15W speakers for clear high-definition audio.



ENERGY STAR® certified

This is an environmentally-friendly ENERGY STAR certified product.



Plug and Play Android Apps

Useful pre-installed applications

The embedded Android OS allows you to use a wide range of pre-installed applications such as whiteboard and wireless presentation applications right out of the box. Apps are easily accessible from a list screen and can also be managed in folders for each purpose.



Application store Google Play store

Users have direct access to the Google Play store and can install a variety of applications depending on their usage scenario.

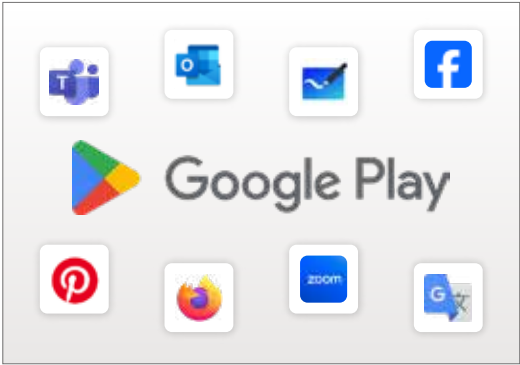

Seamless wireless presentation and collaboration EShare

You can perform wireless screencasting from any OS, such as Windows, iOS, Mac, Android, Chrome and Ubuntu. Make your meetings and classes even more efficient thanks to the ability to display up to four screens at once. Operation of PCs is also available from IWB wirelessly.

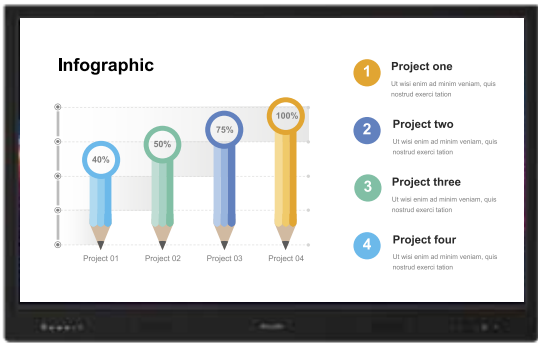

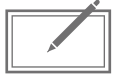

Easy-to-use digital whiteboard

Whiteboard

The digital whiteboard is an excellent tool to maximize collaboration at meetings and classes. When the meeting or class is over, you can save the contents to the cloud for future sharing.

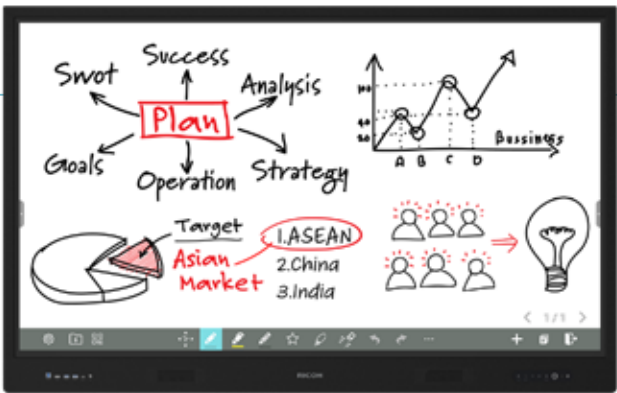

Floating Toolbar

A toolbar with pen and eraser functions and the ability to insert shapes. The handwriting text conversion and handwriting shape conversion functions allow you to convert handwritten text to digital and handwritten shapes to digital. Once converted to text or shapes, size, color, and placement can also be converted.

Option Box

Includes useful classroom and meeting tools such as rulers, sticky notes, mind maps, PDFs, and table inserts. It also includes web search, YouTube viewing, and split-screen capabilities for active collaboration in classrooms and meetings.

Navigation Bar

You can move, add and delete pages, and add up to 299 pages. Various templates are also available, such as background color change, sheet music, soccer court, and so on.



Easier information sharing

Picture in Picture

External video input can be displayed separately on a small screen in a portion of the screen. This allows you to review multiple pieces of information at the same time, enabling efficient information sharing in various situations such as meetings, classes, and presentations.

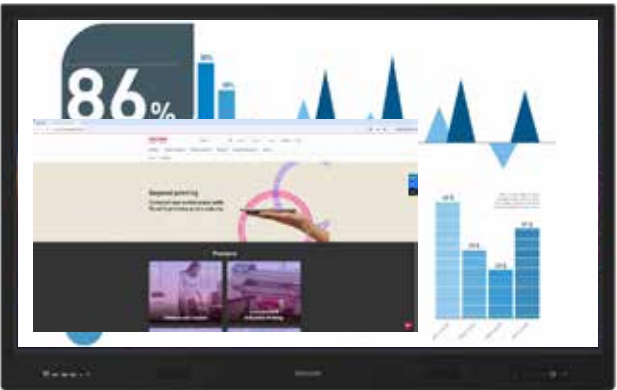

Effectively communicate information on a large screen

Signage

Text information, images, and videos can be inserted and displayed on the screen based on a template. In addition to use as a welcome board, information can be displayed on a large screen, making it useful for communicating information at events and during emergencies.





Flexible Functions and Solutions

Frustration-free user experience with USB Type-C connection

The included USB Type-C cable allows you to simultaneously send images, pass along touch controls, and supply power to the device all with a single cable. By simply plugging in, you can freely perform operations on your PC directly from the IWB.

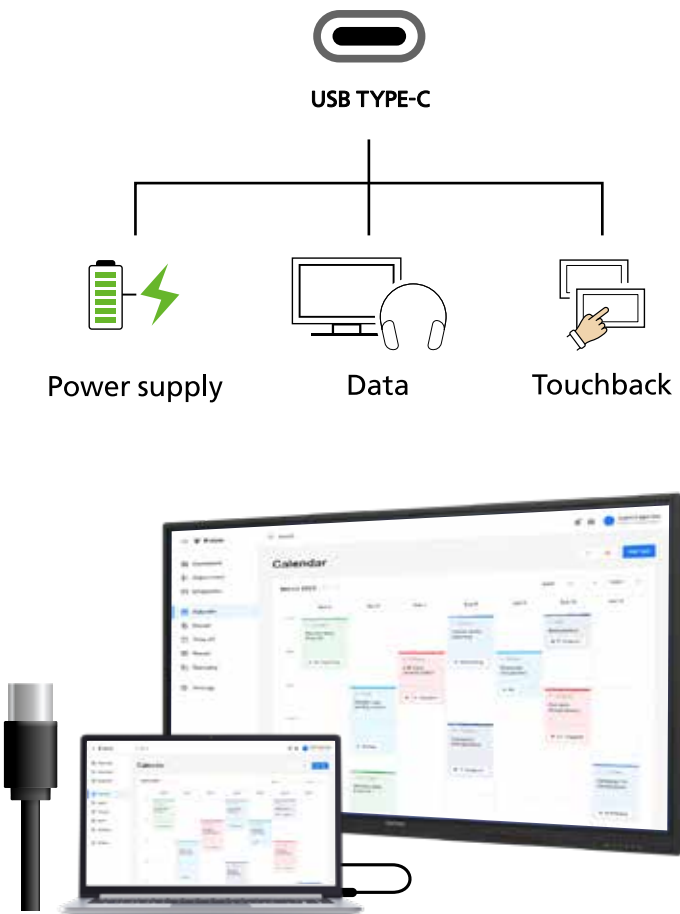

Overlay annotation and smooth capture

The embedded annotation tool allows you to annotate on any displayed image. You can easily capture annotations on a displayed image and then paste the image onto the white-board. This can then be saved as the meeting minutes after finishing discussions.



Customizing the IWB by user account

Log in with the account you added to the IWB to access the personal environment you set up. If the IWB is shared by multiple users, different accounts can improve usability and prevent data confusion. You can add up to 25 accounts.

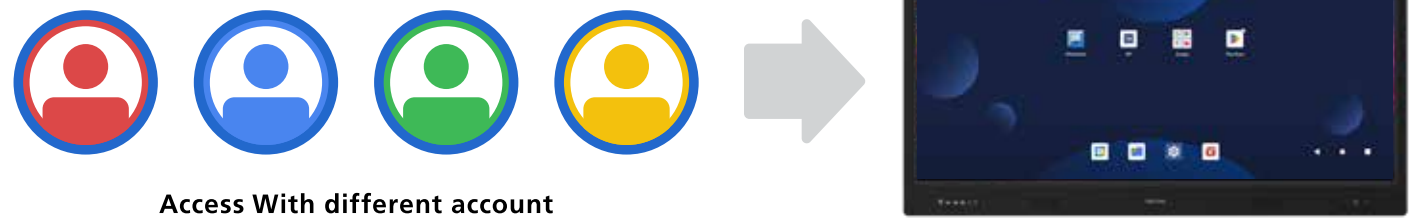

Various Use Scenes

When you need it, where you need it,
more convenience with the Floating Bar

The Floating Bar is an innovative feature that accelerates user interaction when using IWB. The ball can be moved anywhere on the screen, and the user can show or hide it as needed. In addition, a long press allows users to customize their own shortcuts for frequently used operations.



OPTION



*This is an image picture

RICOH IWB Software Suite for Windows

Dedicated software for Windows OPS with annotation, whiteboard and wireless projection functions. The top screen of the dedicated launcher provides an easy-to-view, easy-to-use screen display for highly accessible usability.

Specifications RICOH Interactive Whiteboard A6510

General	
Front interfaces	<ul style="list-style-type: none">1x USB Type C in (Full/PD65W)2x USB 3.0 Type A—public use1x USB 3.0 Type—touch use1x HDMI 2.0 in1x Mic in
Side interfaces	<ul style="list-style-type: none">2x USB 3.0 Type A—public use1x USB Type C (Full/PD15W)3x USB 3.0 Type—touch use2x HDMI 2.0 in1x DisplayPort in1x OPS Slot
Bottom interfaces	<ul style="list-style-type: none">1x RS2321x Audio out1x Line out or Headphone1x SPDIF1x HDMI 2.0 out1x USB 3.0 Type A 3.0 for Android2x 1000Base-T LAN
Dimensions (W x D x H)	1,513 x 92.5 x 953 mm
Weight (kg)	39
Housing material (face frame/back shell)	Aluminum/metal plate
Housing colour (face frame/back shell)	Black/black
VESA	4-M8 screw hole 600 mm x 400 mm
RAM	8 GB
ROM (storage)	128 GB

Environmental	
Power requirements	220–240 V, 50 Hz
Power consumption: maximum	380 W or less
Power consumption: Eco Mode	133 W or less
Power consumption: standby	0.5 W or less
Power consumption: Off Mode	0.3 W or less
Power on duration (excluding standby time)	Maximum daily operating hours are 18 hours per day (24 hours). Do not use the device continuously/intermittently for more than 18 hours per day. Failure to do so could result in device malfunction.
Operating temperature	0–42°C
Operating humidity	20–80%
Storage temperature	-10–50°C
Storage humidity	15–80%

Display panel	
Panel size	65"
Display type	Vertical Alignment (HVA) LED
Backlight	Direct LED
Effective display area	1,428 x 803 mm
Resolution	3,840 x 2,160 pixels (4K)
Colours: maximum	1.07 billion
Brightness: maximum (cd/m²)	400
Contrast ratio	5000:1
Pixel pitch (mm)	0.124 mm (H) x 0.372 mm (V)
Response time (ms)	6.5
Refresh rate (Hz)	60
Viewing angle: H/V (°)	178
LED life	50,000 hours

Touch system	
Technology	Infrared touch frame, zero bonding
Touch points: maximum	40
Resolution	32,768 x 32,768—interpolated
Pen request	Pen tip (thin)—2.8 mm in diameter; Pen tip (thick)—10 mm in diameter
Sensor accuracy	±1 mm
Connection type	USB 2.0
Cover glass	3.2 mm ± 0.2 mm
Supported OS environments	<ul style="list-style-type: none">Windows 11, 10Mac OS 10.14 or laterAndroidLinux—Ubuntu KylinChrome

Software	
Operating system	Android 13.0 EDLA
Pre-installed apps—Google	Maps, Meet, Photos, Play Store, Safety, Settings, YouTube, YTMusic, Calculator, Calendar, Camera, Chrome, Clock, Contacts, Drive, Files, Assistant, Keep Notes, Docs, Sheets, Slides, Google Admin
Pre-installed apps—other	Whiteboard, Files, EsharePro, PIP, Hardware Detect, Signage, Visualizer, Voice Recorder, Vote, Radix Viso MDM
Default functions	Welcome screen (Launcher), Source setting, Annotation tool, Stopwatch, Eye-protection, Spotlight, Screen record, Screen capture, Split screen, Floating bar, Toolbar

What's included	
<ul style="list-style-type: none">Touch pen x2Read This First sheetQuick Guide sheetRemote controllerAAA batteries x2Power cord (3 m)	<ul style="list-style-type: none">USB-C cable (2 m)USB A-B cable (3 m)HDMI 2.0 cable (3 m)Plastic clamp (3 pcs + 3 pcs)

Wireless	
WiFi standard	IEEE802.11a/b/g/n/ac/ax (WiFi6)
WiFi operating frequency	2.4 GHz/5 GHz
Bluetooth	5.2



Specifications RICOH Interactive Whiteboard A7510

General	
Front interfaces	<ul style="list-style-type: none">1x USB Type C in (Full/PD65W)2x USB 3.0 Type A—public use1x USB 3.0 Type—touch use1x HDMI 2.0 in1x Mic in
Side interfaces	<ul style="list-style-type: none">2x USB 3.0 Type A—public use1x USB Type C (Full/PD15W)3x USB 3.0 Type—touch use2x HDMI 2.0 in1x DisplayPort in1x OPS Slot
Bottom interfaces	<ul style="list-style-type: none">1x RS2321x Audio out1x Line out or Headphone1x SPDIF1x HDMI 2.0 out1x USB 3.0 Type A 3.0 for Android2x 1000Base-T LAN
Dimensions (W x D x H)	1,735 x 92.4 x 1,077 mm
Weight (kg)	52
Housing material (face frame/back shell)	Aluminum/metal plate
Housing colour (face frame/back shell)	Black/black
VESA	4-M8 screw hole 800 mm x 400 mm
RAM	8 GB
ROM (storage)	128 GB

Display panel	
Panel size	75"
Display type	Vertical Alignment (HVA) LED
Backlight	Direct LED
Effective display area	1,650 x 928 mm
Resolution	3,840 x 2,160 pixels (4K)
Colours: maximum	1.07 billion
Brightness: maximum (cd/m²)	400
Contrast ratio	5500:1
Pixel pitch (mm)	0.14325 mm (H) x 0.14325 mm (V)
Response time (ms)	6.5
Refresh rate (Hz)	60
Viewing angle: H/V (°)	178
LED life	50,000 hours

Environmental	
Power requirements	220–240 V, 50 Hz
Power consumption: maximum	420 W or less
Power consumption: Eco Mode	150 W or less
Power consumption: standby	0.5 W or less
Power consumption: Off Mode	0.3 W or less
Power on duration (excluding standby time)	Maximum daily operating hours are 18 hours per day (24 hours). Do not use the device continuously/intermittently for more than 18 hours per day. Failure to do so could result in device malfunction.
Operating temperature	0–42°C
Operating humidity	20–80%
Storage temperature	-10–50°C
Storage humidity	15–80%

Touch system	
Technology	Infrared touch frame, zero bonding
Touch points: maximum	40
Resolution	32,768 x 32,768—interpolated
Pen request	Pen tip (thin)—2.8 mm in diameter; Pen tip (thick)—10 mm in diameter
Sensor accuracy	±1 mm
Connection type	USB 2.0
Cover glass	3.2 mm ± 0.2 mm
Supported OS environments	<ul style="list-style-type: none">Windows 11, 10Mac OS 10.14 or laterAndroidLinux—Ubuntu KylinChrome

Software	
Operating system	Android 13.0 EDLA
Pre-installed apps—Google	Maps, Meet, Photos, Play Store, Safety, Settings, YouTube, YTMusic, Calculator, Calendar, Camera, Chrome, Clock, Contacts, Drive, Files, Assistant, Keep Notes, Docs, Sheets, Slides, Google Admin
Pre-installed apps—other	Whiteboard, Files, EsharePro, PIP, Hardware Detect, Signage, Visualizer, Voice Recorder, Vote, Radix Viso MDM
Default functions	Welcome screen (Launcher), Source setting, Annotation tool, Stopwatch, Eye-protection, Spotlight, Screen record, Screen capture, Split screen, Floating bar, Toolbar

What's included	
<ul style="list-style-type: none">Touch pen x2Read This First sheetQuick Guide sheetRemote controllerAAA batteries x2Power cord (3 m)	<ul style="list-style-type: none">USB-C cable (2 m)USB A-B cable (3 m)HDMI 2.0 cable (3 m)Plastic clamp (3 pcs + 3 pcs)

Wireless	
WiFi standard	IEEE802.11a/b/g/n/ac/ax (WiFi6)
WiFi operating frequency	2.4 GHz/5 GHz
Bluetooth	5.2

Specifications RICOH Interactive Whiteboard A8610

General		Display panel	
Front interfaces	<ul style="list-style-type: none">1x USB Type C in (Full/PD65W)2x USB 3.0 Type A—public use1x USB 3.0 Type—touch use1x HDMI 2.0 in1x Mic in	Panel size	86"
Side interfaces	<ul style="list-style-type: none">2x USB 3.0 Type A—public use1x USB Type C (Full/PD15W)3x USB 3.0 Type—touch use2x HDMI 2.0 in1x DisplayPort in1x OPS Slot	Display type	Vertical Alignment (HVA) LED
Bottom interfaces	<ul style="list-style-type: none">1x RS2321x Audio out1x Line out or Headphone1x SPDIF1x HDMI 2.0 out1x USB 3.0 Type A 3.0 for Android2x 1000Base-T LAN	Backlight	Direct LED
Dimensions (W x D x H)	1,981 x 92.2 x 1,217 mm	Effective display area	1,895 x 1,065 mm
Weight (kg)	65	Resolution	3,840 x 2,160 pixels (4K)
Housing material (face frame/back shell)	Aluminum/metal plate	Colours: maximum	1.07 billion
Housing colour (face frame/back shell)	Black/black	Brightness: maximum (cd/m²)	400
VESA	4-M8 screw hole 800 mm x 400 mm	Contrast ratio	4000:1
RAM	8 GB	Pixel pitch (mm)	0.4935 mm (H) x 0.4935 mm (V)
ROM (storage)	128 GB	Response time (ms)	8.0
		Refresh rate (Hz)	60
		Viewing angle: H/V (°)	178
		LED life	50,000 hours

Software	
Operating system	Android 13.0 EDLA
Pre-installed apps—Google	Maps, Meet, Photos, Play Store, Safety, Settings, YouTube, YTMusic, Calculator, Calendar, Camera, Chrome, Clock, Contacts, Drive, Files, Assistant, Keep Notes, Docs, Sheets, Slides, Google Admin
Pre-installed apps—other	Whiteboard, Files, EsharePro, PIP, Hardware Detect, Signage, Visualizer, Voice Recorder, Vote, Radix Viso MDM
Default functions	Welcome screen (Launcher), Source setting, Annotation tool, Stopwatch, Eye-protection, Spotlight, Screen record, Screen capture, Split screen, Floating bar, Toolbar

Environmental	
Power requirements	220–240 V, 50 Hz
Power consumption: maximum	520 W or less
Power consumption: Eco Mode	168 W or less
Power consumption: standby	0.5 W or less
Power consumption: Off Mode	0.3 W or less
Power on duration (excluding standby time)	Maximum daily operating hours are 18 hours per day (24 hours). Do not use the device continuously/intermittently for more than 18 hours per day. Failure to do so could result in device malfunction.
Operating temperature	0–42°C
Operating humidity	20–80%
Storage temperature	-10–50°C
Storage humidity	15–80%

What's included

- Touch pen x2
- Read This First sheet
- Quick Guide sheet
- Remote controller
- AAA batteries x2
- Power cord (3 m)
- USB-C cable (2 m)
- USB A-B cable (3 m)
- HDMI 2.0 cable (3 m)
- Plastic clamp (3 pcs + 3 pcs)

Touch system	
Technology	Infrared touch frame, zero bonding
Touch points: maximum	40
Resolution	32,768 x 32,768—interpolated
Pen request	Pen tip (thin)—2.8 mm in diameter; Pen tip (thick)—10 mm in diameter
Sensor accuracy	±1 mm
Connection type	USB 2.0
Cover glass	3.2 mm ± 0.2 mm
Supported OS environments	<ul style="list-style-type: none">• Windows 11, 10• Mac OS 10.14 or later• Android• Linux—Ubuntu Kylin• Chrome

Wireless

WiFi standard	IEEE802.11a/b/g/n/ac/ax (WiFi6)
WiFi operating frequency	2.4 GHz/5 GHz
Bluetooth	5.2



URL: <http://www.minosha.in>

MINOSHA PRINT SOLUTIONS PRIVATE LIMITED
CORPORATE OFFICE: Plot No, 25, Okhla Phase- 3, New Delhi, 110020
Tel: 011- 42266250, Email: info@minosha.in, Service toll free number: 1800 103 0066 & 1800 116 600
REGISTERED OFFICE: Quest,1073, Rajabhau Desai Marg, Behind Beau Monde Towers, Prabhadevi, Mumbai, Maharashtra- 400025
Tel: +91-22-69394444
Banglore, Chennai, Delhi, Hyderabad, Kolkata, Ahemdabad, Mumbai & Pune.

For more information, please contact: